

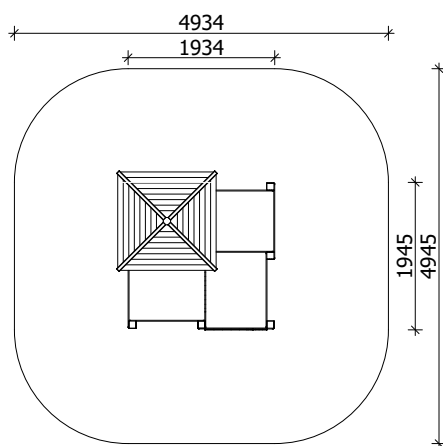

A diagram of a ladder with a vertical back and horizontal rungs. The rungs are labeled with their heights from the bottom: 1 m and 2 m.



A 3D rendering of a wooden playhouse. It features a grey, multi-tiered roof. The main body is constructed from wooden panels in purple and orange. There are circular cutouts in the panels, some of which are covered with grey or orange mesh. The playhouse is supported by wooden posts, some of which have green caps. The entire structure is set against a plain white background.



Length of safety area: 4 934 mm
Width of safety area: 4 945 mm
Required safety area: 22,5 m²

